



Mercy Health

Care first

# Your accommodation options



## Mercy Place Ballarat

60 Corbett Street  
Ballarat East Vic 3350  
Phone 03 5327 1888  
MPBallarat@mercy.com.au

[mercyhealth.com.au](http://mercyhealth.com.au)



# Our home



At Mercy Place Ballarat, we offer a new experience in aged care where you and your family can feel right at home. Our innovative small household living approach promotes independence, choice and relationships, with residents living in small households supported by a dedicated team of care staff.

Mercy Place Ballarat has 14 households and each one is designed for up to eight residents. There is a broad range of stylishly designed room options spread over three floors, with each household featuring its own modern kitchen, open-plan living and dining areas, and laundry.



Living in a small household provides the opportunity for your care team to get to know you, your family and what is important to you. Likewise, you can get to know your care team and fellow residents. Residents, families and staff are encouraged to work together to enjoy meaningful daily activities both within the home and outside it.

The contemporary design, natural light and stunning views at Mercy Place Ballarat make it the perfect place to relax with family and friends.

Mercy Place Ballarat provides additional services for residents. Please speak with the Service Manager for a full list of services and the cost.

# Choosing a room

Enjoy the high-quality furniture and fittings including wall-mounted flat-screen TVs, in-room air conditioning and heating, built-in wardrobes and ample space for your personal treasures. There are built-in technologies to enhance health, comfort and privacy. Each room has its own private ensuite and couples can take advantage of double or adjoining rooms. Add a touch of luxury by choosing a room with a private balcony, bay window or sweeping views of Ballarat.





# Your care team

---

Each household is supported by dedicated care staff who will get to know you and how you like to spend your day. They will help you and your fellow residents plan the weekly menu and organise social activities and outings.

A registered nurse is on site 24 hours a day, seven days a week if you need them. There is also a clubs and events manager, clinical health and wellness manager, maintenance officer and extended local team to help you make the most out of life at Mercy Place Ballarat.

Mercy Health is a trusted aged care provider, offering a safer choice for you and your family.

Grounded in a 2,000-year tradition of caring for others, we provide a wide range of flexible and personalised care options.



# The precinct

---

Mercy Place Ballarat is designed for your convenience, so you can find everything you need right outside your front door.

Residents can attend events, join clubs, visit our wellness centre or enjoy our gardens.

At the Village Square, grab a coffee with family or friends in the cafe or go shopping at the grocer. Attend services in the chapel or if you fancy getting your hair done, make an appointment in the hairdressing salon. At Mercy Place Ballarat you will also find a pub with an outdoor balcony, and a club lounge with a large terrace. For special visits with the grandchildren, take them to the kid's playground. The men's shed and a craft room also provide the perfect opportunity to enjoy the activities you love.



## Our rooms

You can choose to pay for your room by a **Refundable Accommodation Deposit (RAD)**, a **Daily Accommodation Payment (DAP)** or any combination you choose. A RAD is paid as a lump sum. A DAP accrues daily and is paid periodically, for example monthly. A combination payment includes a partial lump sum and daily payments. We also offer a drawdown option.

See our *Understanding the costs* brochure for an explanation of payment options or speak to us about how we can tailor a payment package to suit your needs.

FEATURES						PAYMENT OPTIONS			
	Room	Ensuite	Size	Floor	Extra	RAD	DAP	Combination payment example (50% RAD + 50% DAP)	
Grande	Single	Private	13m <sup>2</sup>	G, 1		\$	\$	RAD \$	+ DAP \$
Deluxe	Single	Private	13m <sup>2</sup>	1, 2	Upper level views	\$	\$	RAD \$	+ DAP \$
Deluxe+	Single	Private	13–14m <sup>2</sup>	G, 1, 2	Desk or bay window	\$	\$	RAD \$	+ DAP \$
Premier	Single	Private	13–14m <sup>2</sup>	1, 2	Desk or bay window with upper level views	\$	\$	RAD \$	+ DAP \$
Premier+	Single	Private	15m <sup>2</sup>	1, 2	Larger room	\$	\$	RAD \$	+ DAP \$
Superior	Single	Private	17–21m <sup>2</sup>	G	Large corner room	\$	\$	RAD \$	+ DAP \$
Superior+	Single	Private	17–21m <sup>2</sup>	G, 1, 2	Larger corner room with balcony or outside access	\$	\$	RAD \$	+ DAP \$
Executive	Single and double	Private	24–28m <sup>2</sup>	1,2	Spacious room with private balcony	\$	\$	RAD \$	+ DAP \$

Prices are effective as of \_\_\_\_\_ and are subject to change.

# Mercy Place Ballarat – Ground floor

## GRANDE

Our stylish Grande rooms offer private ensuites, independently controlled heating and cooling, and built-in wardrobes. Located on the ground and first floors, these contemporary rooms provide a peaceful space to relax.

## DELUXE+

These highly sought-after Deluxe+ rooms are available on all three floors of Mercy Place Ballarat. The rooms have plenty of space, with features including a private ensuite, large bay windows or a desk. Some Deluxe+ rooms also offer views of the tranquil reflection garden.

## SUPERIOR

Our ground-floor Superior rooms offer pleasant garden views and plenty of natural light. Each of these large corner rooms has a private ensuite and provides direct access to our home's beautifully designed gardens.

## SUPERIOR+

Occupying prime corner positions and extra floor space, these Superior+ rooms are ideal for welcoming family and friends. Situated on all three floors of Mercy Place Ballarat, the rooms feature either a privacy balcony or direct access to our manicured gardens.

### HOUSE 1

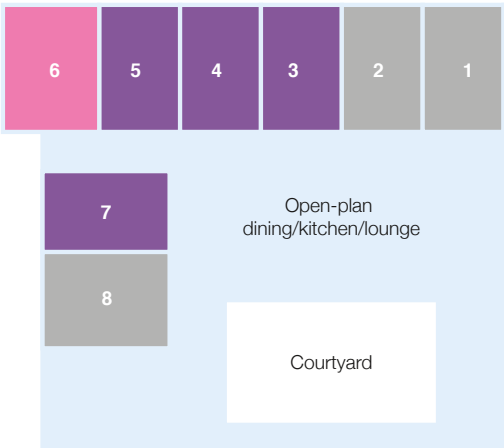

### HOUSE 3

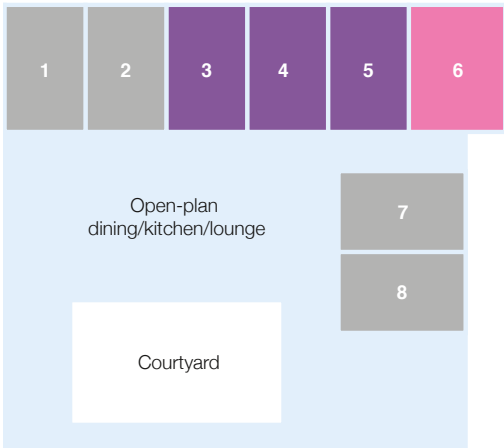

### HOUSE 2

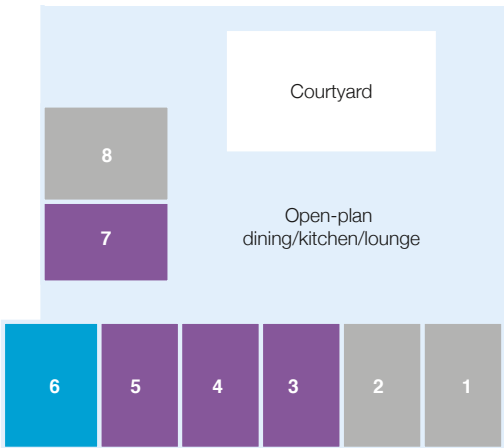

### HOUSE 4

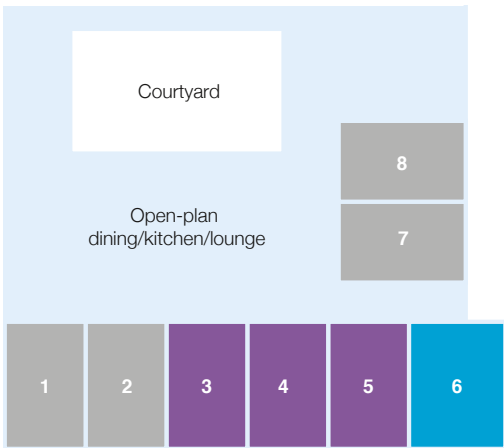

# Mercy Place Ballarat – First floor

## GRANDE

## DELUXE

These modern rooms on the first and second floors are a popular choice, featuring private ensuites, air conditioning and heating, and built-in wardrobes. Some of our Deluxe rooms also offer access to an adjoining room, which can be used as a second bedroom or additional living area.

## DELUXE+

## PREMIER

These beautiful, light-filled rooms on the first and second floors offer a bay window or study nook with views of the landscaped gardens. Some rooms are situated close to our home's terraced areas and you will also enjoy stunning views of Ballarat.

## PREMIER+

Our Premium+ rooms are located on the first and second floors with most rooms offering private balconies for your enjoyment. These rooms are stylishly appointed and feature private ensuites, heating and cooling and a built-in wardrobe.

*Room descriptions continue on next page.*

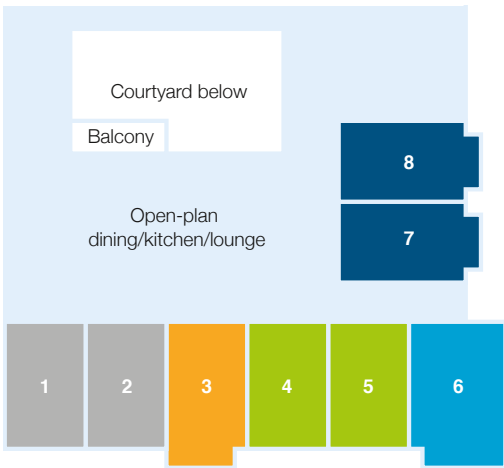
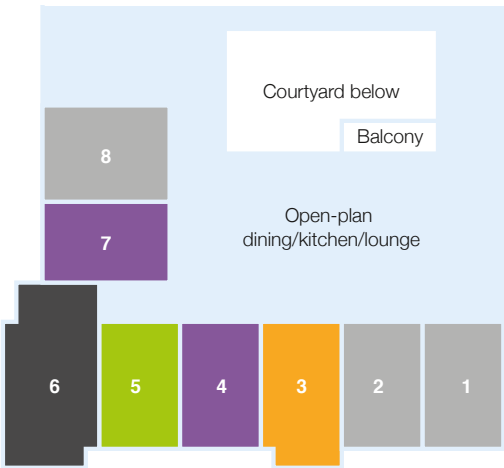
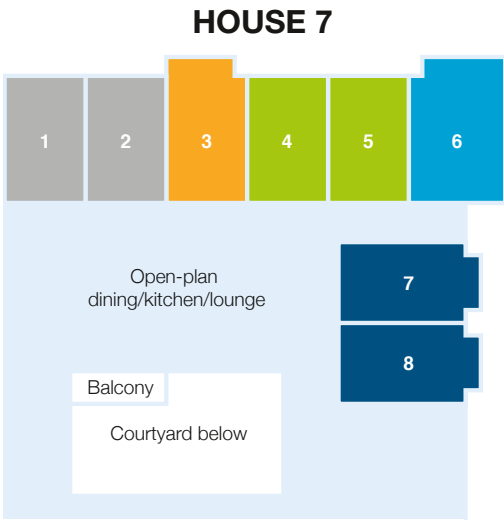
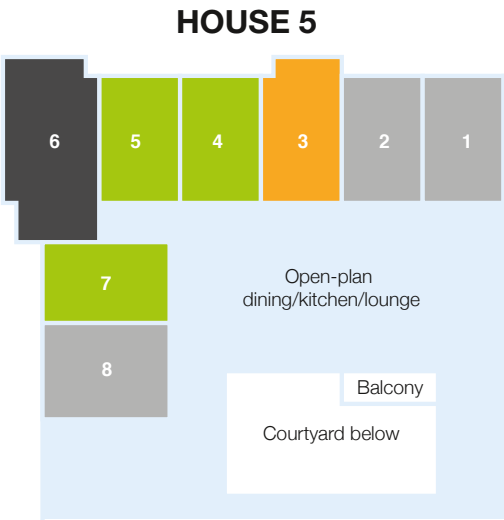

# Mercy Place Ballarat – First floor *(continued)*

**SUPERIOR+**

**EXECUTIVE**

Snap up one of just five luxurious Executive suites located in prime positions on the first and second floors of Mercy Place Ballarat. Measuring 24–28m<sup>2</sup>, these extra-large corner rooms feature private balconies, stylish furniture and fittings, and sweeping views of the Ballarat region.

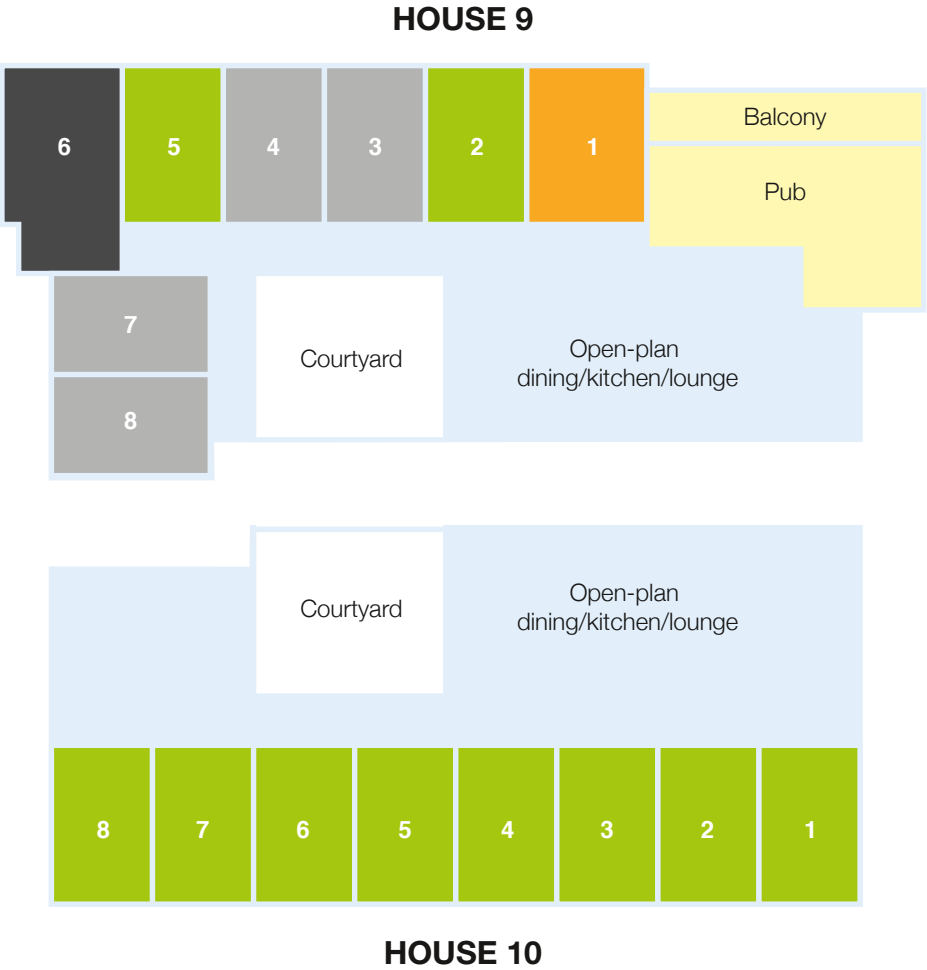

# Mercy Place Ballarat – Second floor

DELUXE

DELUXE+

PREMIER

PREMIER+

SUPERIOR+

EXECUTIVE

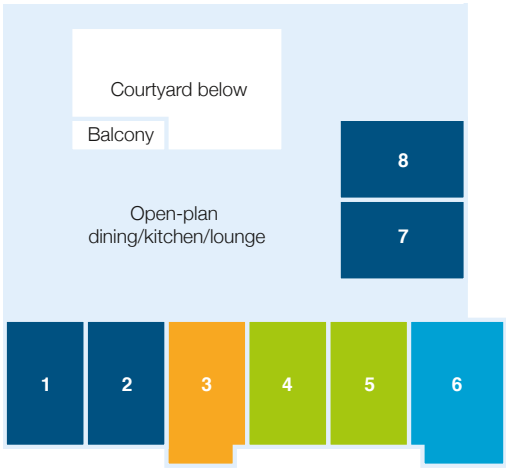
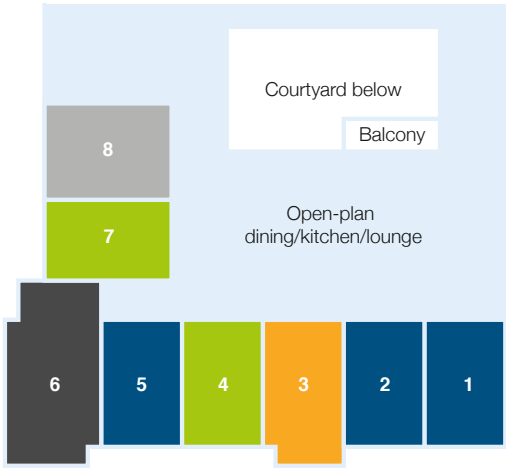
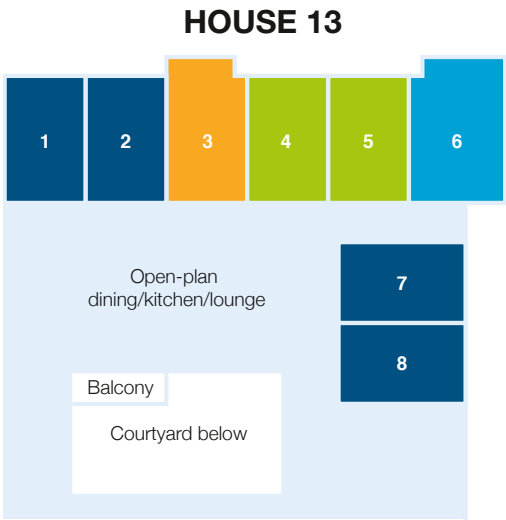
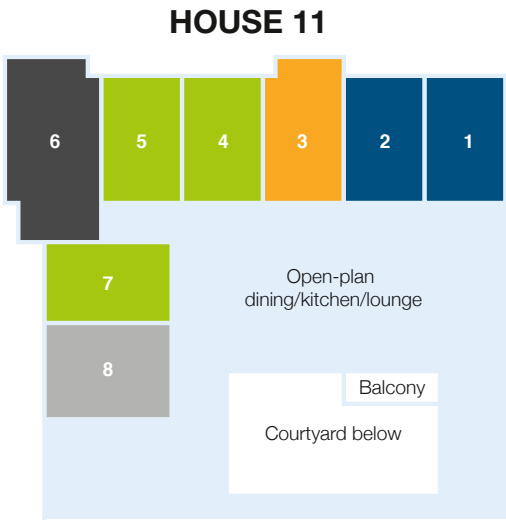



Call now to book  
a personal tour  
of Mercy Place  
Ballarat.

The modern story of Mercy Health began with the founding of the Order of the Sisters of Mercy in Dublin in 1831 by Catherine McAuley, who dedicated her life to serving people in need.

The Sisters of Mercy went on to found convents, schools and hospitals across the globe. They arrived in Australia in 1846, led by Mother Ursula Frayne.

Following a devastating influenza pandemic, the Sisters of Mercy opened their first Victorian hospital — St Benedict's in Malvern — in 1920.

As Mercy Health, they established a reputation for excellence in care and hospitality that has grown in strength to this day.

A leading Catholic provider of health, aged and community services, our history and future is based on responding to the most significant needs of the time.

We employ and care for people of all faiths and no faith. Our people come from many cultures and backgrounds but share a common goal: to provide compassionate and responsive care to people in need.

## Mercy Place Ballarat

60 Corbett Street  
Ballarat East Vic 3350  
Phone 03 5327 1888  
MPBallarat@mercy.com.au

[mercyhealth.com.au](http://mercyhealth.com.au)



Mercy Health acknowledges Aboriginal and Torres Strait Islander Peoples as the first Australians. We acknowledge the diversity of Indigenous Australia. We respectfully recognise Elders past, present and emerging. This brochure was produced on Wurundjeri Country.