



Mercy Health

Care first

# Your accommodation options



## Mercy Place Boronia

7-9 Maryville Way  
Boronia Vic 3155  
Phone 03 9762 6506  
MPBoronia@mercy.com.au

[mercyhealth.com.au](http://mercyhealth.com.au)



# Our home

---

At Mercy Place Boronia, we are proud to provide high-quality care and accommodation where residents can feel safe, comfortable and valued. You can choose from a variety of room layouts, all of which are stylishly decorated for your enjoyment.

Nestled in the foothills of the Dandenong Ranges, our home features a large dining room, a library and cosy sitting areas where you can relax or entertain family and friends. All common areas display contemporary artwork and have well-appointed furniture and premium décor. Enjoy the sunshine in our established gardens or on the deck, marvel at the large indoor aquarium, visit the on-site hairdresser or attend a service or event at our chapel.



# Choosing a room

---

Our lovely rooms are in excellent condition with quality furniture and fittings including wall-mounted flat screen TVs, air conditioning and heating, built-in wardrobes and space for your personal treasures. The rooms in our Lourdes wing are specially designed for people living with dementia. Add a touch of luxury by choosing a room with plenty of natural light or beautiful views.



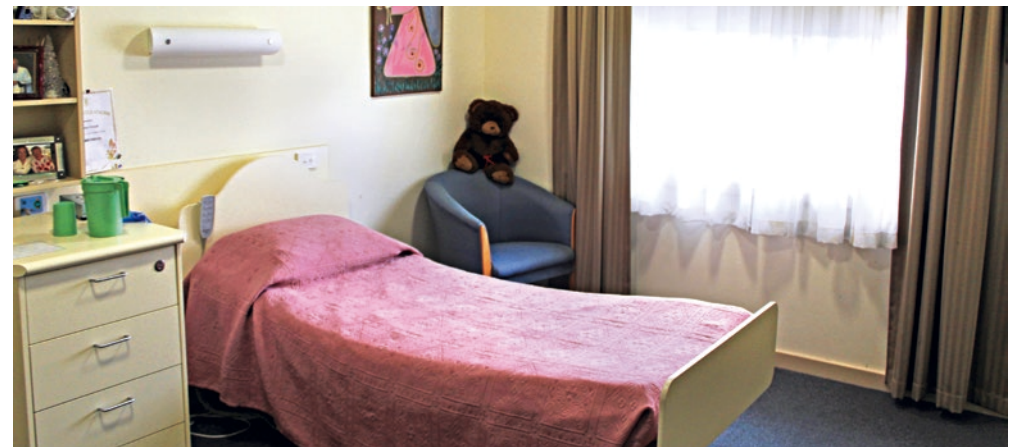

***Find your perfect fit by booking a personal tour. Phone 03 9762 6506.***



# Our rooms

You can choose to pay for your room by a **Refundable Accommodation Deposit (RAD)**, a **Daily Accommodation Payment (DAP)** or any combination you choose. A RAD is paid as a lump sum. A DAP accrues daily and is paid periodically, for example monthly. A combination payment includes a partial lump sum and daily payments. We also offer a drawdown option.

See our *Understanding the costs* brochure for an explanation of payment options or speak to us about how we can tailor a payment package to suit your needs.

		FEATURES					PAYMENT OPTIONS				
		Room	Ensuite	Size	Floor	View	Extra	RAD	DAP	Combination payment example (50% RAD + 50% DAP)	
Classic		Single	Shared bathroom	17m <sup>2</sup>	G			\$	\$	RAD \$	+ DAP \$
Grande		Single	Shared ensuite	17-26m <sup>2</sup>	G			\$	\$	RAD \$	+ DAP \$
Deluxe		Single	Private	17m <sup>2</sup>	G	✓		\$	\$	RAD \$	+ DAP \$
Deluxe+		Single	Private	17m <sup>2</sup>	G	✓		\$	\$	RAD \$	+ DAP \$

Prices are effective as of \_\_\_\_\_ and are subject to change.

# Shepherds Ville and Convent

## DELUXE+

These beautiful Deluxe+ suites in the Lourdes wing are specially designed for people living with dementia. The bright and spacious rooms are designed to maximise safety and independence, offering access to a secure sensory garden that has a lovely water feature. The Deluxe+ rooms have private ensuites and quality fittings, including wall-mounted flat screen TVs and built-in wardrobes.

## DELUXE

Enjoy your own private ensuite in a charming Deluxe room in the Shepherds Ville and Convent wings. Some of the mid-sized rooms offer views of the deck, garden and surrounding neighbourhood. All Deluxe rooms are in excellent condition with wall-mounted flat screen TVs and individually controlled air conditioning and heating.

## GRANDE

Savour views of the deck or garden in these Grande rooms located in the Convent wing. The comfortable rooms have shared ensuites designed with safety and comfort in mind, as well as quality furnishings and fixtures including wall-mounted flat screen TVs, a high-low bed and air conditioning and heating for your comfort.

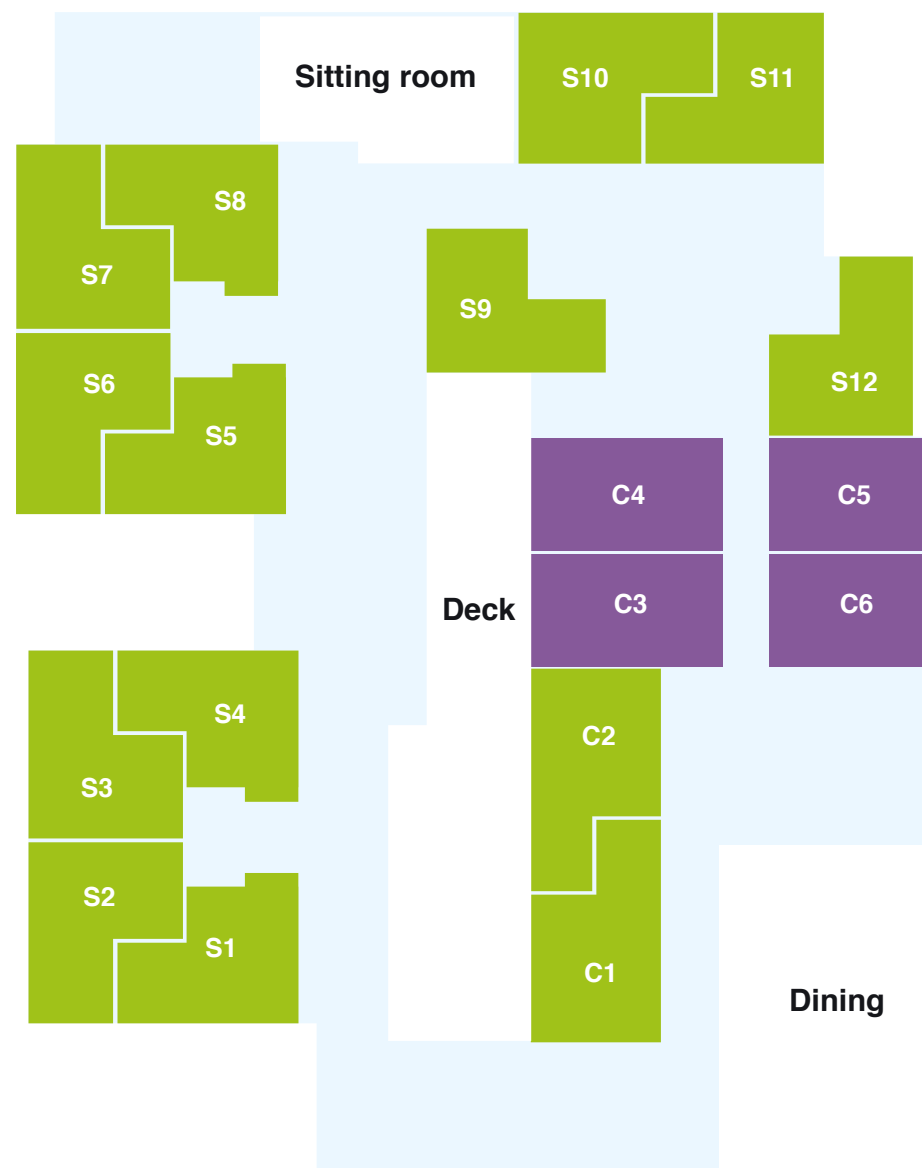

# Lourdes

DELUXE

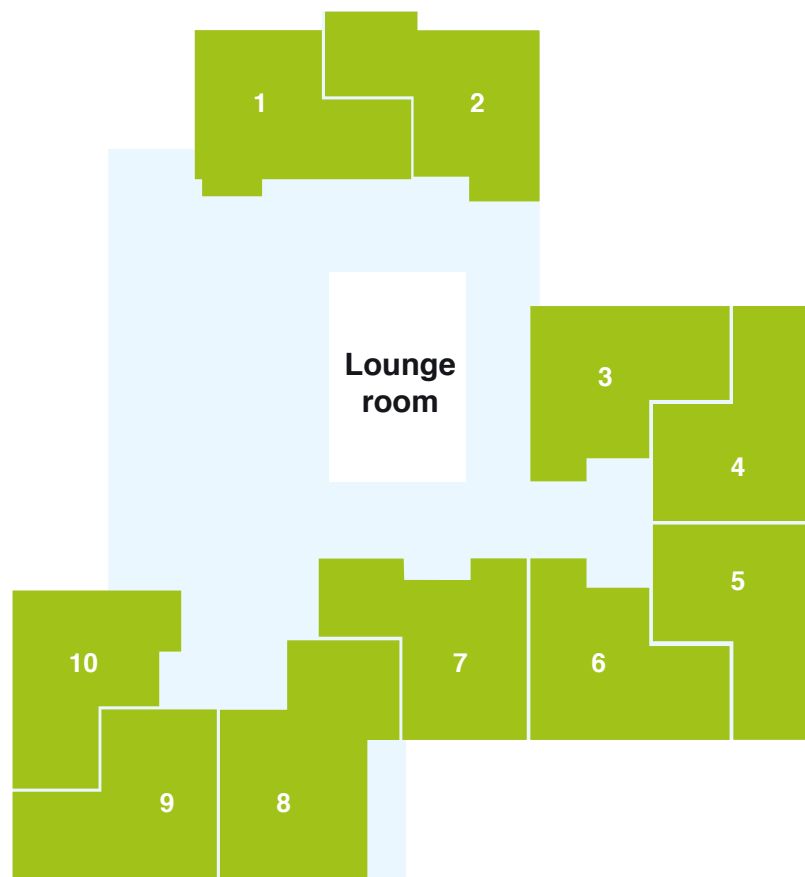

# Rosary Court

## CLASSIC

These cosy Classic rooms within the Rose-a-lea, Chapel View, Rosary Court and Tecoma wings offer shared bathrooms designed to maximise safety and independence. The well-maintained rooms have quality fittings as well as built-in wardrobes to store your belongings.

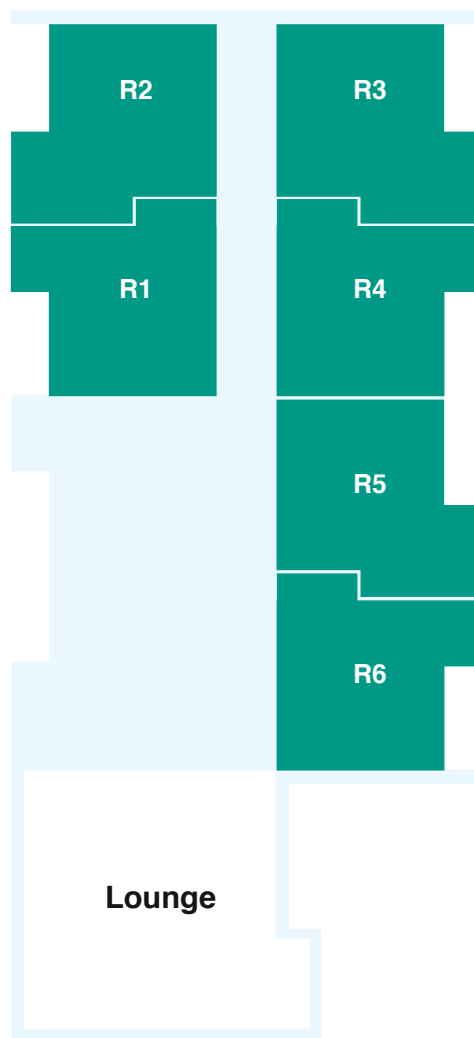

# Tecoma

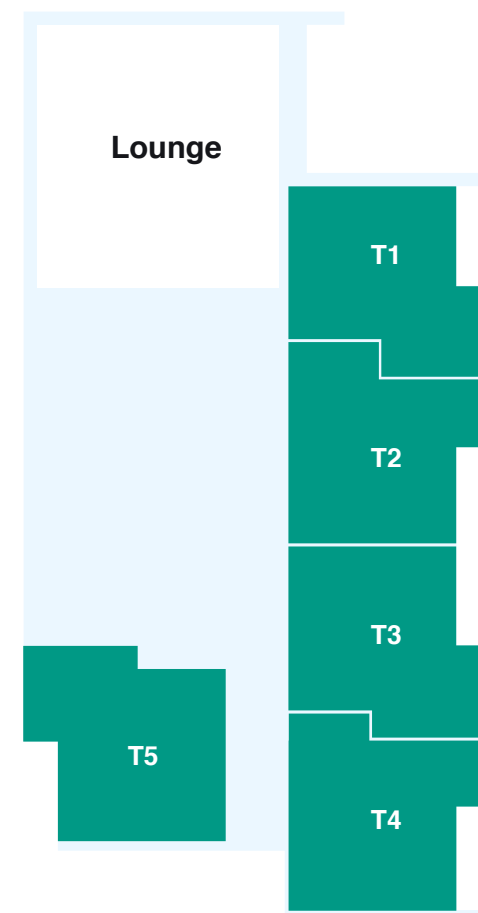

# Chapel View

# Rose-a-lea

CLASSIC

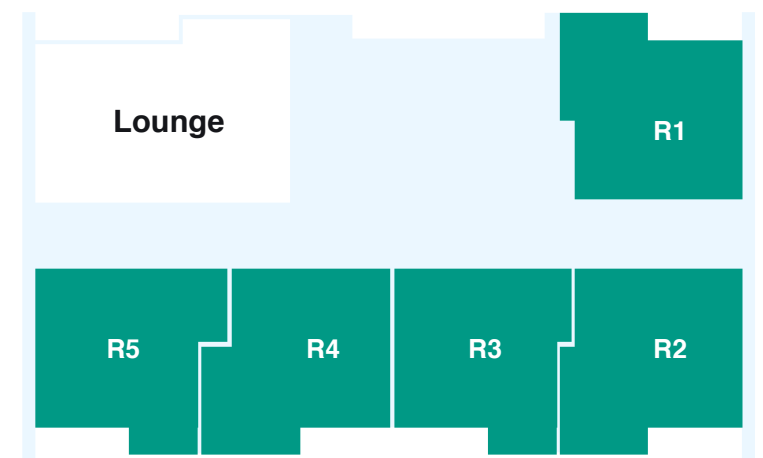
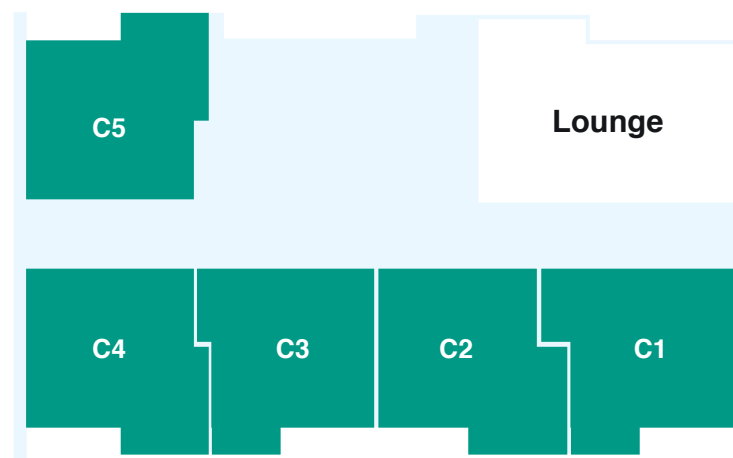

# Overview

---

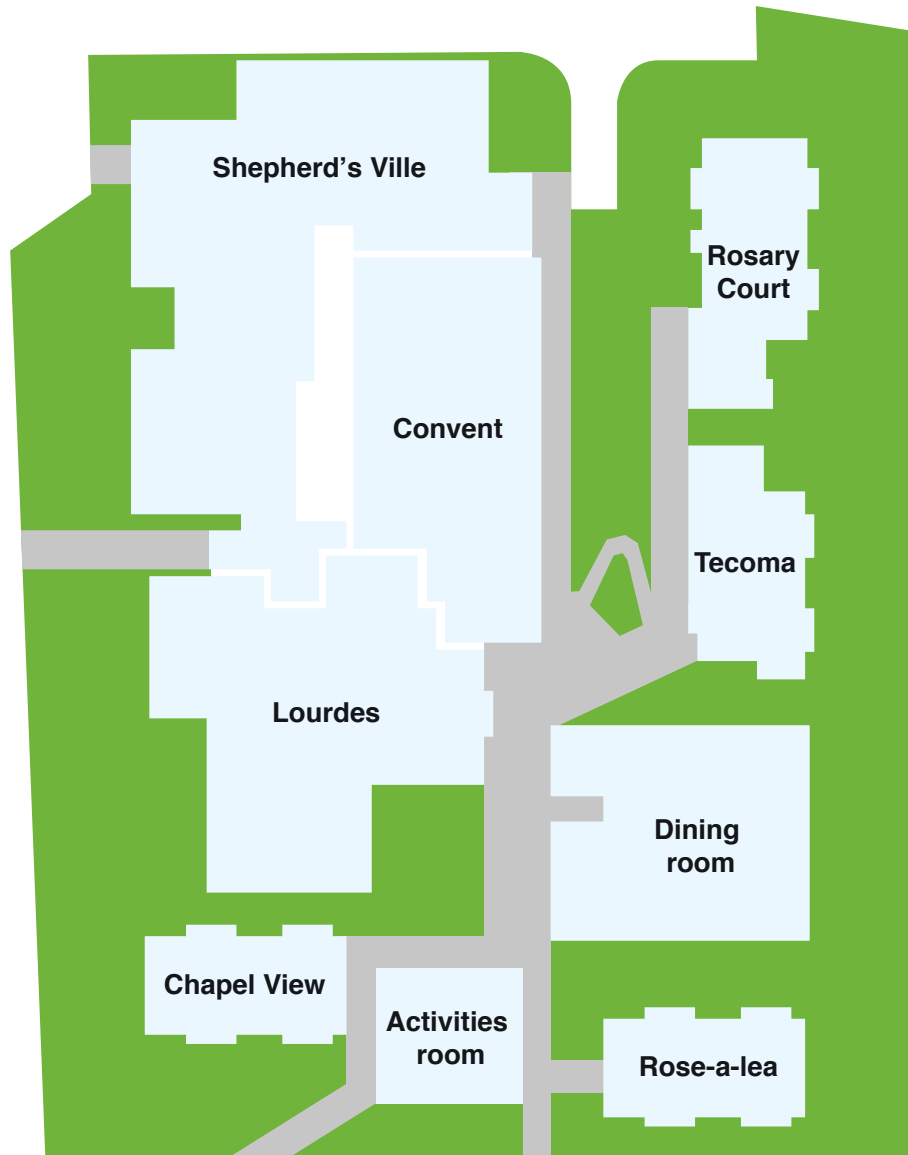

Mercy Health acknowledges Aboriginal and Torres Strait Islander Peoples as the first Australians. We acknowledge the diversity of Indigenous Australia. We respectfully recognise Elders both past and present.