



Mercy Health

Care first

# Your accommodation options



## Mercy Place Mount St Joseph's

61 Campbell Street

Young NSW 2594

Phone 02 6380 1300

Information-MSJ@mercy.com.au

[mercyhealth.com.au](http://mercyhealth.com.au)



# Our home

---

At Mercy Place Mount St Joseph's, we are proud to provide high-quality care and accommodation where residents can feel safe, comfortable and valued. You can choose from a variety of room layouts, all of which are stylishly decorated with modern amenities for your enjoyment.

Our spacious and historic home features four households, which are designed to look and feel just like home, with their own familiar kitchen, dining and living room.

Enjoy the sunshine in our gardens, visit the hairdresser, attend a service in our beautiful chapel or meet friends for coffee at our café.



# Choosing a room

---

Our lovely rooms are maintained in good condition. Enjoy the high-quality furniture and fittings, including centrally controlled air conditioning and heating, built-in wardrobes and space for your personal treasures. Choose a room with plenty of natural light or beautiful views.

***Find your perfect fit by booking a personal tour.  
Phone 02 6380 1300.***



# Our rooms

You can choose to pay for your room by a **Refundable Accommodation Deposit (RAD)**, a **Daily Accommodation Payment (DAP)** or any combination you choose. A RAD is paid as a lump sum. A DAP accrues daily and is paid periodically, for example monthly. A combination payment includes a partial lump sum and daily payments. We also offer a drawdown option.

See our *Understanding the costs* brochure for an explanation of payment options or speak to us about how we can tailor a payment package to suit your needs.

|         | FEATURES |         |                     |       |      |       | PAYMENT OPTIONS |     |                                                 |          |
|---------|----------|---------|---------------------|-------|------|-------|-----------------|-----|-------------------------------------------------|----------|
|         | Room     | Ensuite | Size                | Floor | View | Extra | RAD             | DAP | Combination payment example (50% RAD + 50% DAP) |          |
| Classic | Shared   | Shared  | 33–34m <sup>2</sup> | G     |      |       | \$              | \$  | RAD \$                                          | + DAP \$ |
| Deluxe  | Single   | Private | 15–17m <sup>2</sup> | G     | ✓    |       | \$              | \$  | RAD \$                                          | + DAP \$ |
| Suite   | Single   | Private | 33–34m <sup>2</sup> | G     |      |       | \$              | \$  | RAD \$                                          | + DAP \$ |

Prices are effective as of \_\_\_\_\_ and are subject to change.

# Boronia

## CLASSIC

Our well-maintained Classic shared rooms are the perfect solution for couples or friends, old and new. Located throughout the home, the Classic rooms offer a shared ensuite designed to maximise safety and independence, as well as good-quality furniture and fittings.

## DELUXE

Savour your own private space in a beautiful Deluxe room at Mercy Place Mount St Joseph's. The highly sought-after single rooms are in excellent condition, boasting private ensuites, good-quality furniture and fittings and ample space to store or display your treasures.

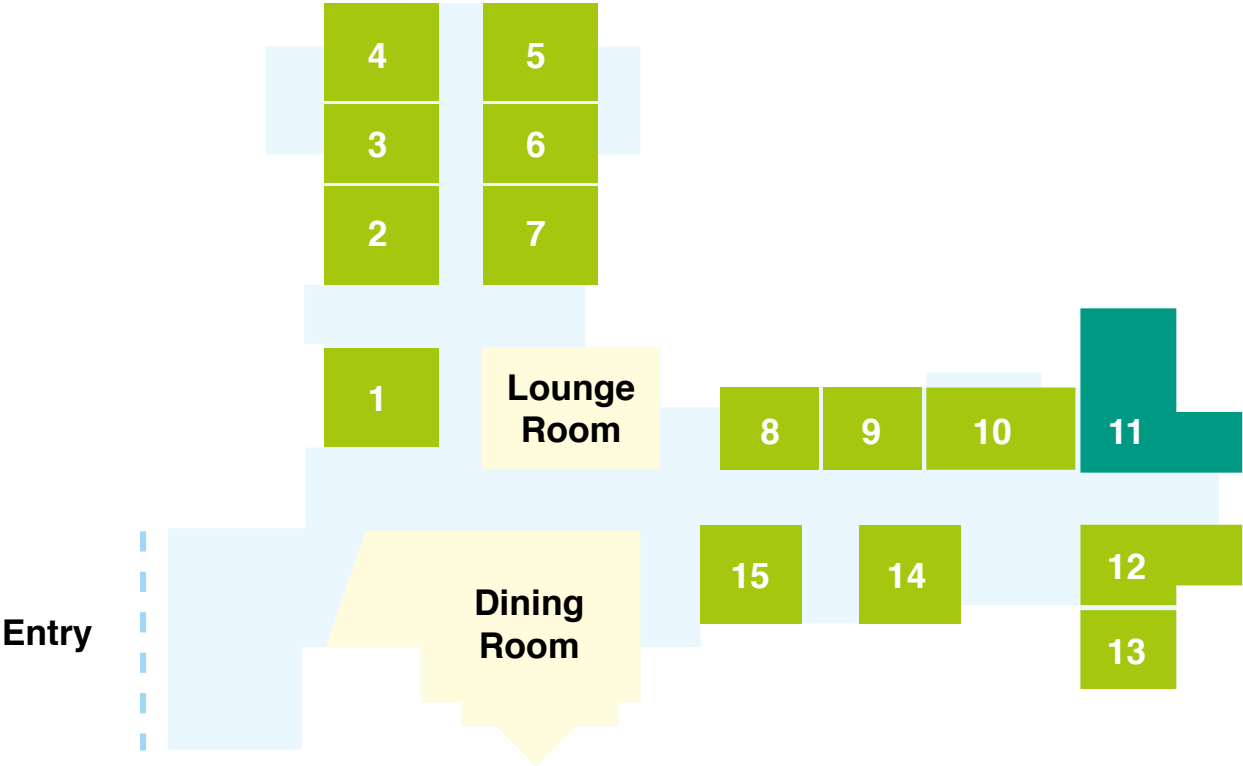

# Grevillea

DELUXE

SUITE

Our spacious Suites offer a King-single bed with a private ensuite. Host visitors in the well-furnished lounge area or just enjoy the additional space to relax in comfort.

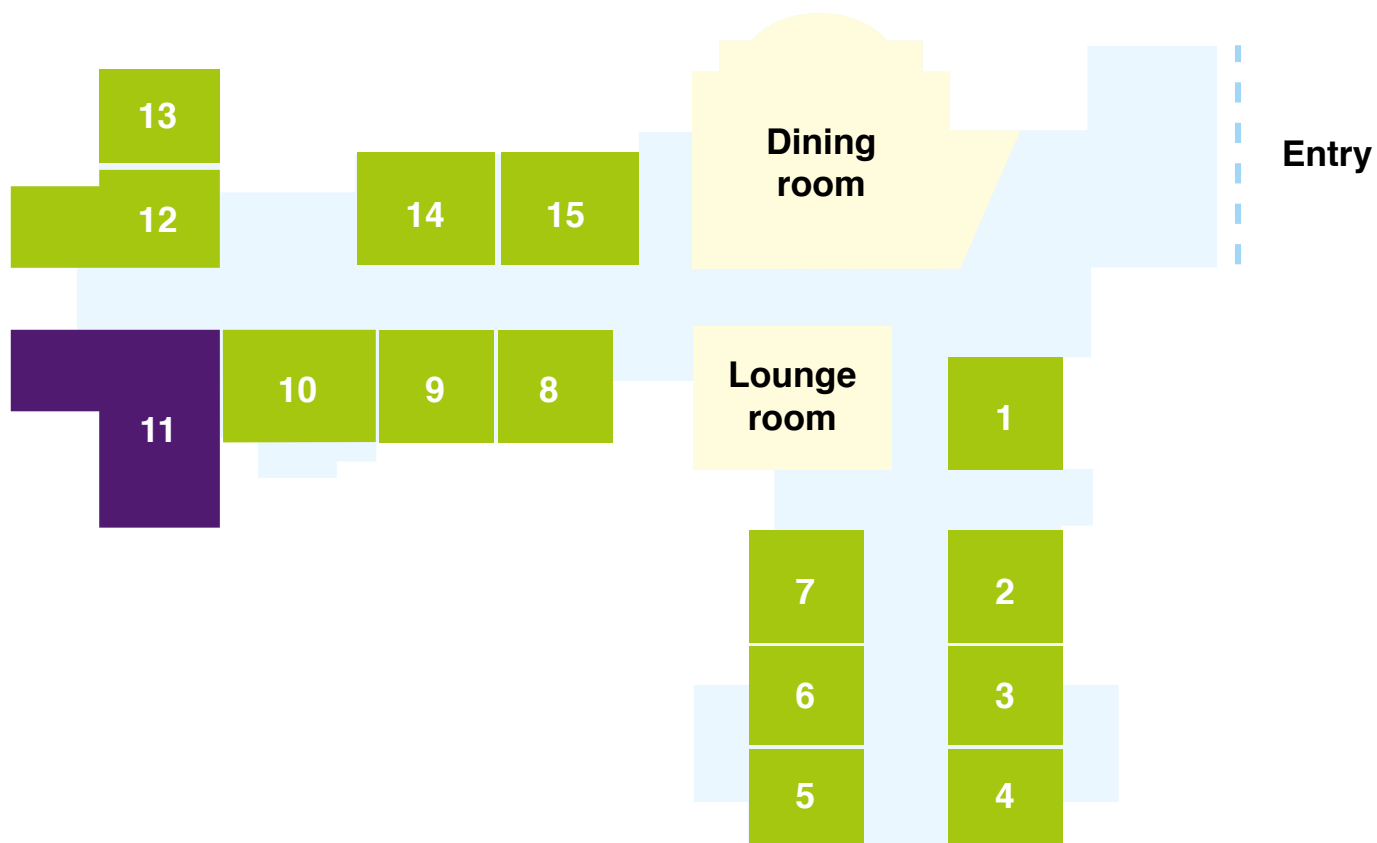

# Banksia

DELUXE

SUITE

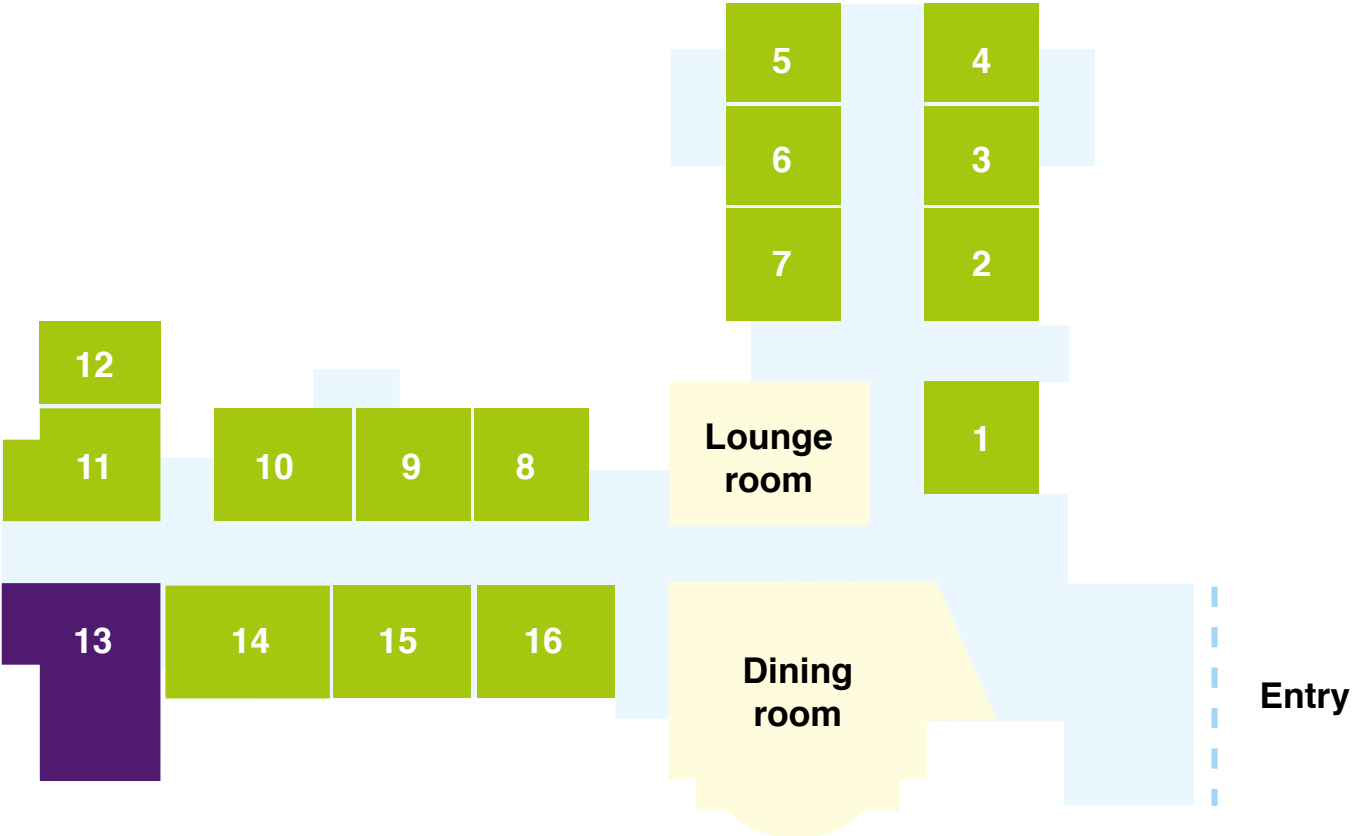

# Waratah

CLASSIC

DELUXE

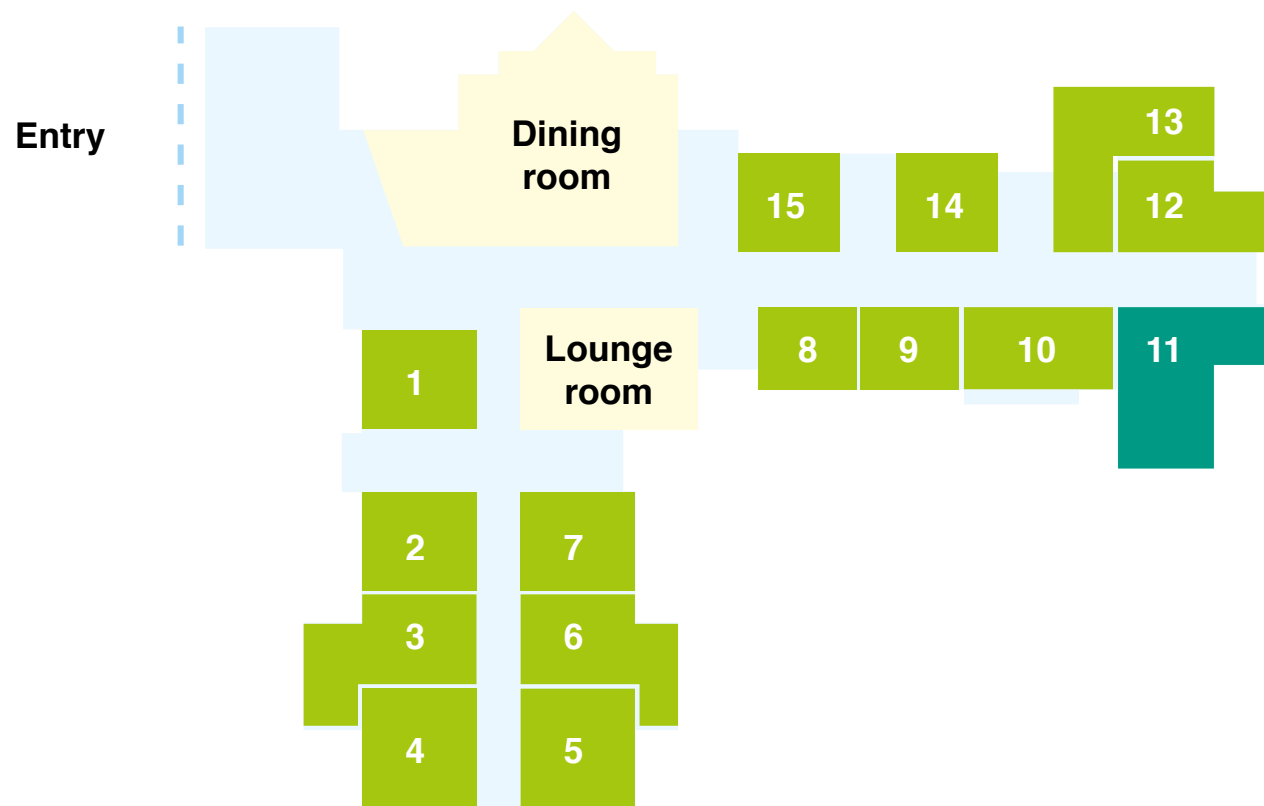



Call now to book a personal tour  
of Mercy Place Mount St Joseph's.

## Mercy Place Mount St Joseph's

61 Campbell Street

Young NSW 2594

Phone 02 6380 1300

Information-MSJ@mercy.com.au

[mercyhealth.com.au](http://mercyhealth.com.au)

Mercy Health acknowledges  
Aboriginal and Torres Strait  
Islander Peoples as the first  
Australians. We acknowledge the  
diversity of Indigenous Australia.  
We respectfully recognise Elders  
past, present and emerging.