



Mercy Health

Care first

Your accommodation options



Mercy Place Abbotsford

2 Clarke Street

Abbotsford Vic 3067

Phone 03 9419 3933

MPAbbotsford@mercy.com.au

mercyhealth.com.au



Our home

At Mercy Place Abbotsford, we are proud to provide high-quality care and accommodation where residents can feel safe, comfortable and valued. You can choose from a variety of rooms within this wonderful inner-city neighbourhood, just a hop, skip and a jump away from the Collingwood Children's Farm, popular cafes and the serene Yarra River.

Our lovely home features two large dining rooms, a library and computer rooms. Many of our lounge and sitting areas offer scenic views of the stunning Abbotsford Convent, making them the perfect locations to relax or entertain family and friends. Savour the sunshine in our sensory garden or courtyard, visit the on-site hairdresser or attend a service or event at the beautiful chapel.



Choosing a room

Our rooms are all tastefully fitted with comfortable furniture including a bed, bedside table and over-bed table. A 24/7 Nurse Call system is available in all rooms, giving you and your loved ones peace of mind. Take advantage of the wardrobes with space for your personal treasures, or display your favourite items to personalise your room. Add a touch of luxury by choosing a room with plenty of natural light or beautiful views.

Find your perfect fit by booking a personal tour. Phone 03 9419 3933.



Our rooms

You can choose to pay for your room by a **Refundable Accommodation Deposit (RAD)**, a **Daily Accommodation Payment (DAP)** or any combination you choose. A RAD is paid as a lump sum. A DAP accrues daily and is paid periodically, for example monthly. A combination payment includes a partial lump sum and daily payments. We also offer a drawdown option.

See our *Understanding the costs* brochure for an explanation of payment options or speak to us about how we can tailor a payment package to suit your needs.

FEATURES							PAYMENT OPTIONS			
	Room	Ensuite	Size	Floor	View	Extra	RAD	DAP	Combination payment example (50% RAD + 50% DAP)	
Classic+	Shared 2-bed	Shared bathroom	17-30m ²	G			\$	\$	RAD \$	+ DAP \$
Grande	Single	Shared bathroom	12-17m ²	G, 1	✓	Scenic views	\$	\$	RAD \$	+ DAP \$
Grande+	Single	Shared ensuite	10-17m ²	G, 1	✓		\$	\$	RAD \$	+ DAP \$
Deluxe	Single	Private	16-17m ²	G, 1	✓	Scenic views	\$	\$	RAD \$	+ DAP \$
Deluxe+	Single	Private	16-20m ²	1	✓	City views	\$	\$	RAD \$	+ DAP \$

Prices are effective as of _____ and are subject to change.

Ground floor

CLASSIC+

Enjoy views of the courtyard or Clarke Street from a Classic+ room on the ground floor. The bright and spacious two-person rooms have access to a shared bathroom designed to maximise safety and independence, as well as high-quality furnishings.

GRANDE

Savour your own space in a well-appointed Grande room on the ground or first floor, some of which offer views across the church courtyard, garden or Clarke Street. The Grande rooms have shared bathrooms, and heating and cooling for your comfort.

GRANDE+

Located on the ground and first floors, these desirable Grande+ rooms offer plenty of natural light and shared ensuites or private w.c. The Grande+ suites have attractive furniture and fittings including a wardrobe and bedside table.

DELUXE

With your own private ensuite and a delightful view of the Mercy Place Abbotsford courtyard, you will love spending time in your Deluxe room. The charming room boasts good-quality fittings as well as heating and cooling.

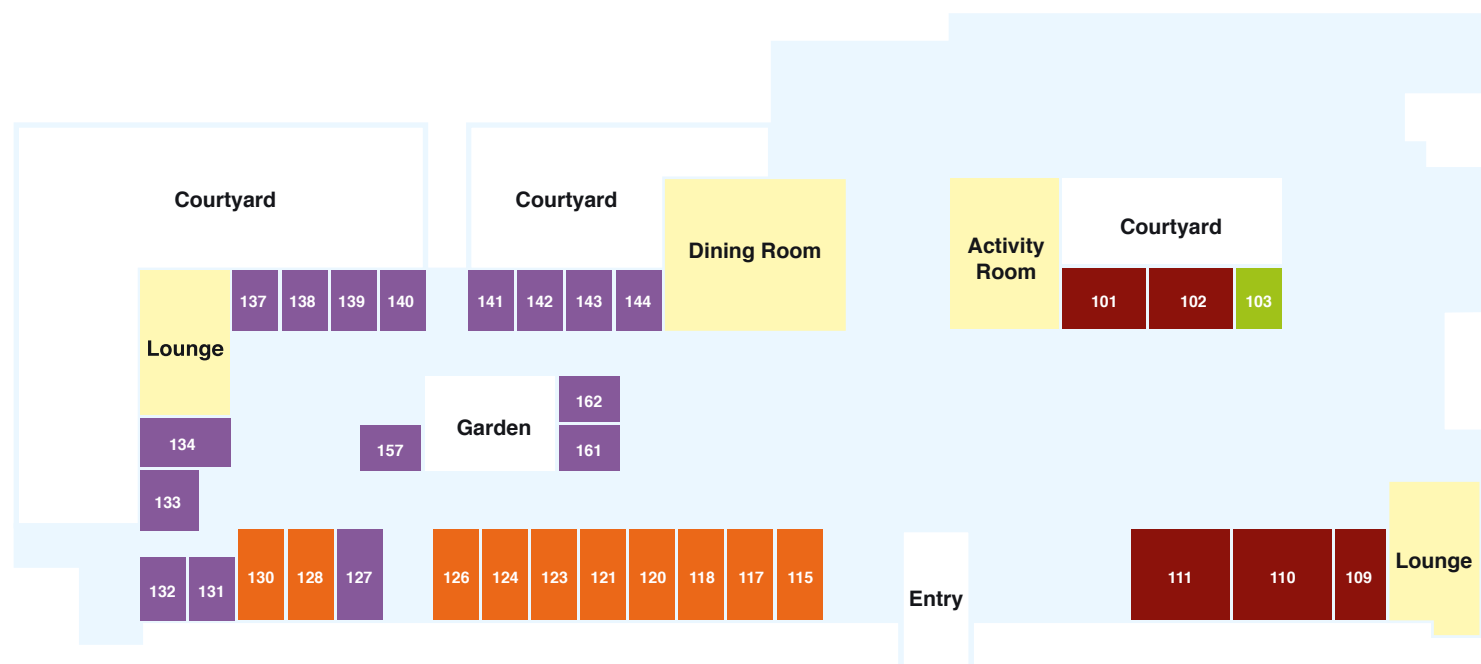

First floor

DELUXE+

The morning light shines bright in this east-facing Deluxe+ suite. The spacious first-floor room has its own private ensuite and good-quality furniture and fittings including a wardrobe with plenty of space to store your treasures.

DELUXE

GRANDE

GRANDE+

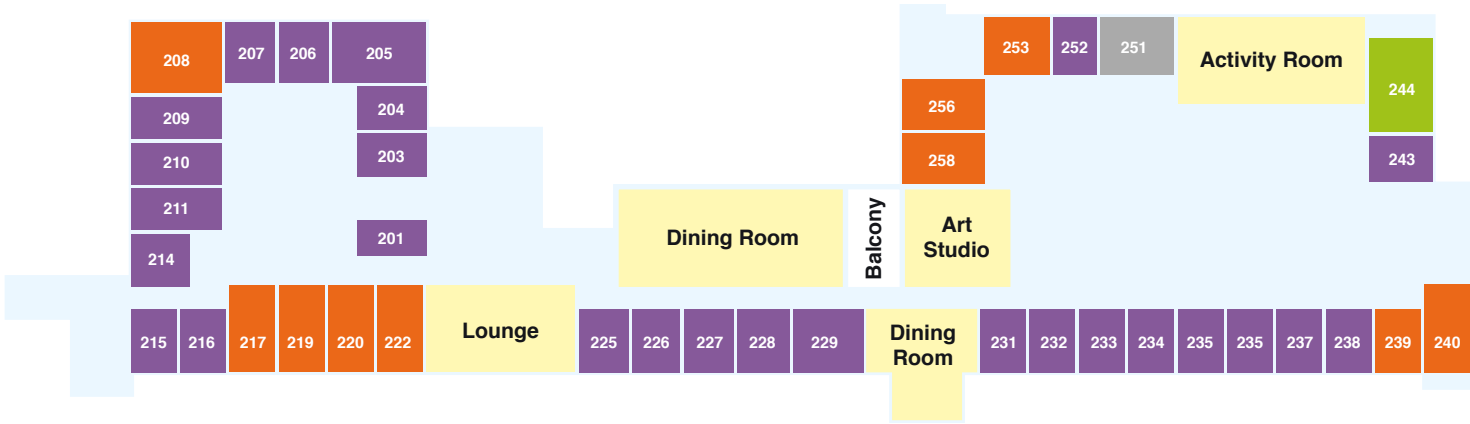

Call now to book a personal tour
of Mercy Place Abbotsford.

Mercy Place Abbotsford

2 Clarke Street

Abbotsford Vic 3067

Phone 03 9419 3933

MPAbbotsford@mercy.com.au

mercyhealth.com.au

Mercy Health acknowledges
Aboriginal and Torres Strait
Islander Peoples as the first
Australians. We acknowledge the
diversity of Indigenous Australia.
We respectfully recognise Elders
both past and present.