



Mercy Health

Care first

# Your accommodation options



## Mercy Place Rice Village

7 Moylan Loop

Marshall, Vic 3216

Phone 03 5247 2200

Information-MPRiceVillage@mercy.com.au

[mercyhealth.com.au](http://mercyhealth.com.au)



# Our home

---

At Mercy Place Rice Village, we are proud to provide high-quality care and accommodation where residents can feel safe, comfortable and valued. Our spacious, friendly home features lounge, activity and dining rooms, as well as fully furnished kitchenettes where you can relax, socialise or entertain family and friends. Enjoy a barbecue in our courtyards or gazebo, play a game of pool in the club room, or produce a creative masterpiece in our arts and crafts room. We also have a stunning chapel with a timber ceiling and stained glass windows where services, activities and events are held.



# Choosing a room

---

Our lovely rooms in St Joseph's House and Catherine McAuley House are all beautifully designed with private ensuites and easy access to common areas. Enjoy the spacious rooms appointed with high-quality fittings, including individually controlled hydronic heating, built-in wardrobes and ample storage for your personal treasures. Most of the rooms also have full-length windows with sliding doors to external gardens or courtyards.

***Find your perfect fit by booking a personal tour.  
Phone 03 5247 2200 today.***



# Our rooms

You can choose to pay for your room by a **Refundable Accommodation Deposit (RAD)**, a **Daily Accommodation Payment (DAP)** or any combination you choose. A RAD is paid as a lump sum. A DAP accrues daily and is paid periodically, for example monthly. A combination payment includes a partial lump sum and daily payments. We also offer a drawdown option.

See our *Understanding the costs* brochure for an explanation of payment options or speak to us about how we can tailor a payment package to suit your needs.

FEATURES							PAYMENT OPTIONS			
	Room	Ensuite	Size	Floor	View	Extra	RAD	DAP	Combination payment example (50% RAD + 50% DAP)	
Classic	Single	Private	15m <sup>2</sup>	G			\$250,000	\$28.08	RAD \$125,000	+ DAP \$14.04
Deluxe	Single	Private	15-20m <sup>2</sup>	G	✓		\$350,000	\$39.32	RAD \$175,000	+ DAP \$19.66
Deluxe+	Single	Private	15-20m <sup>2</sup>	G	✓	Peacefully positioned	\$400,000	\$44.93	RAD \$200,000	+ DAP \$22.47

Prices are effective as of **1 July 2020** and are subject to change.

# Catherine McAuley House

## DELUXE+

Savour the abundant natural light afforded by lovely full-length windows in these Deluxe+ suites, and easy access to landscaped gardens and courtyards. The stylish rooms are peacefully positioned away from the nearby road and offer a private ensuite designed to maximise safety and independence. The Deluxe+ rooms have individually controlled hydronic heaters and ceiling fans, and many also have a kitchenette with space for a bar fridge. With a built-in wardrobe, there's plenty of space for you to store your belongings.

## DELUXE

If you value natural light and easy access to our beautiful courtyards and gardens, you will adore these Deluxe suites with their own full-length windows and sliding doors. The suites have private ensuites and offer individually controlled hydronic heating and ceiling fans as well as a kitchenette with space for a bar fridge, a built-in wardrobe and space for your personal treasures.

## CLASSIC

Tucked away in its own little nook, this quiet Classic room offers a contemporary and stylish design with a private ensuite and high-quality fittings including individually controlled hydronic heating and a ceiling fan. With a built-in wardrobe, there's plenty of space for you to store your belongings.

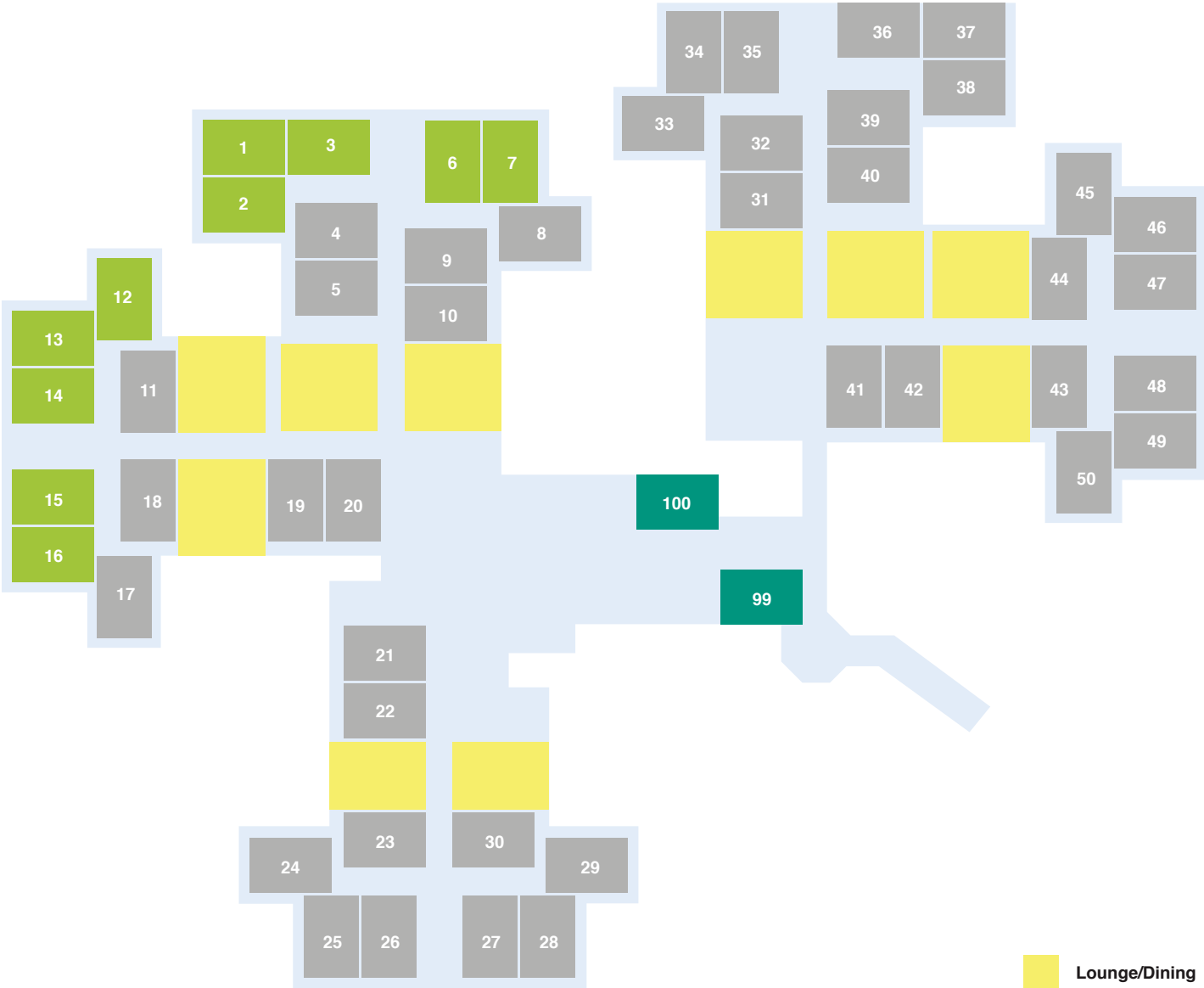

# St Joseph's House

DELUXE+

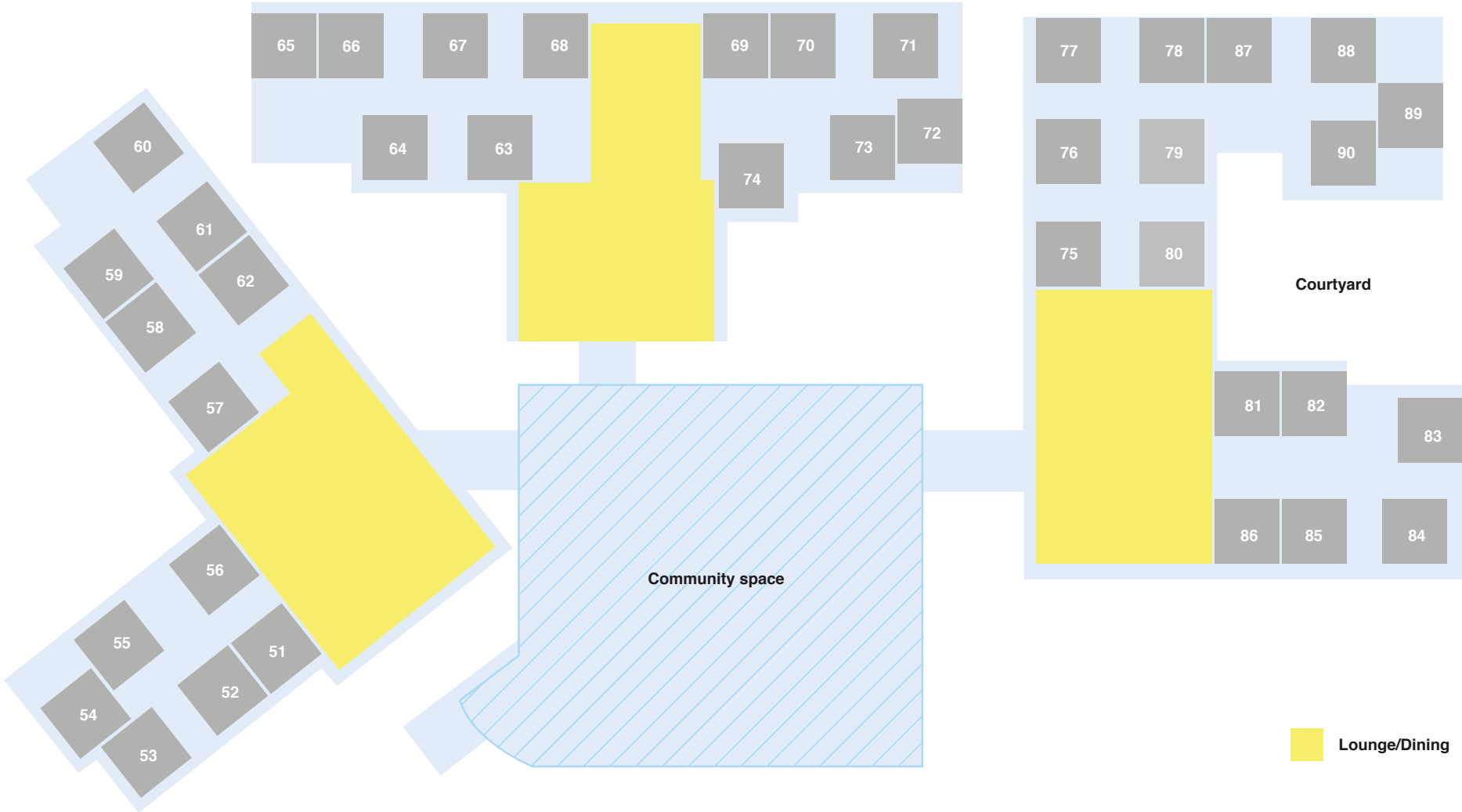

Call now to book a personal tour  
of Mercy Place Rice Village.

## Mercy Place Rice Village

7 Moylan Loop  
Marshall, Vic 3216  
Phone 03 5247 2200  
MPRiceVillage@mercy.com.au

[mercyhealth.com.au](http://mercyhealth.com.au)

Mercy Health acknowledges  
Aboriginal and Torres Strait  
Islander Peoples as the first  
Australians. We acknowledge the  
diversity of Indigenous Australia.  
We respectfully recognise Elders  
both past and present.